

PhoneGnome Whole House Wiring Kit

Installation Instructions

Step 1: Locate the Phone Box

On the outside of your home, you should find a telephone company Network Interface Unit. This is the demarcation point between your wiring and the telephone company's wiring.

NOTE: These instructions apply for interface units as pictured at right. If yours is different, you may need the services of a qualified technician.



Step 2: Disconnect Line 2 at the Phone Box

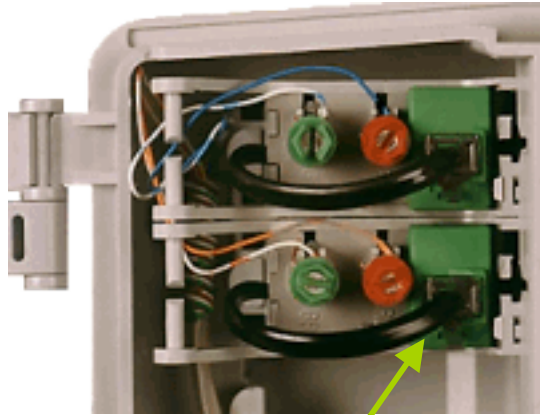

Disconnect this plug
And check for dialtone

If after disconnecting one
plug, there is still dialtone
on L2 then reconnect that
plug and try the other

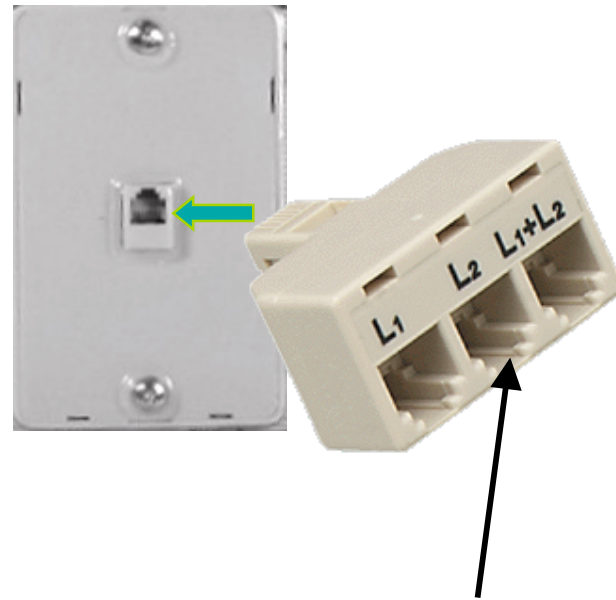

Check for dialtone using
a standard phone and
standard phone cable
plugged in here

Step 3: Mark the Phone Box

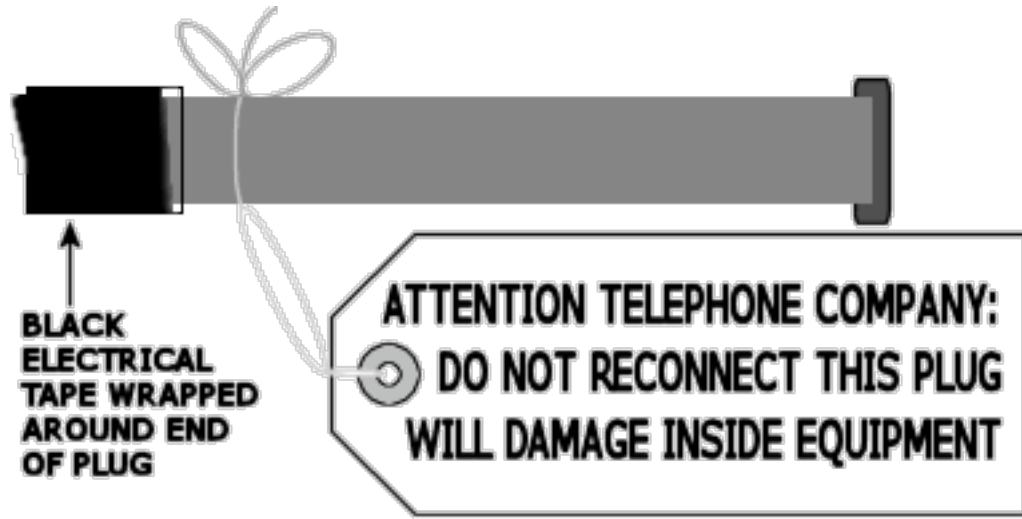

Upon identifying the plug that disables dialtone from L2 in Step 2 wrap the disconnected plug with black plastic electrical tape (or any other vinyl tape you may have). Wrap the plug such that it cannot be plugged back in without removing the tape. Place a tag something like shown above to ensure no one reconnects the plug.

Step 4: Connect The Phone Connections

These instructions assume that your PhoneGnome is operational and has completed its one time setup. Refer to the Quick Setup Guide for initial connection instructions.

Also these instructions refer to telephone connections only (LINE and PHONE ports of the PhoneGnome). The LAN connection is not affected by the Whole House Wiring Kit and should be connected to the Internet as described in the Quick Setup Guide.

Phone line connections are shown for cases requiring DSL filters and those not requiring DSL filters.

Step 4a: Phone Connections with Cable Internet (when DSL filters are not required)

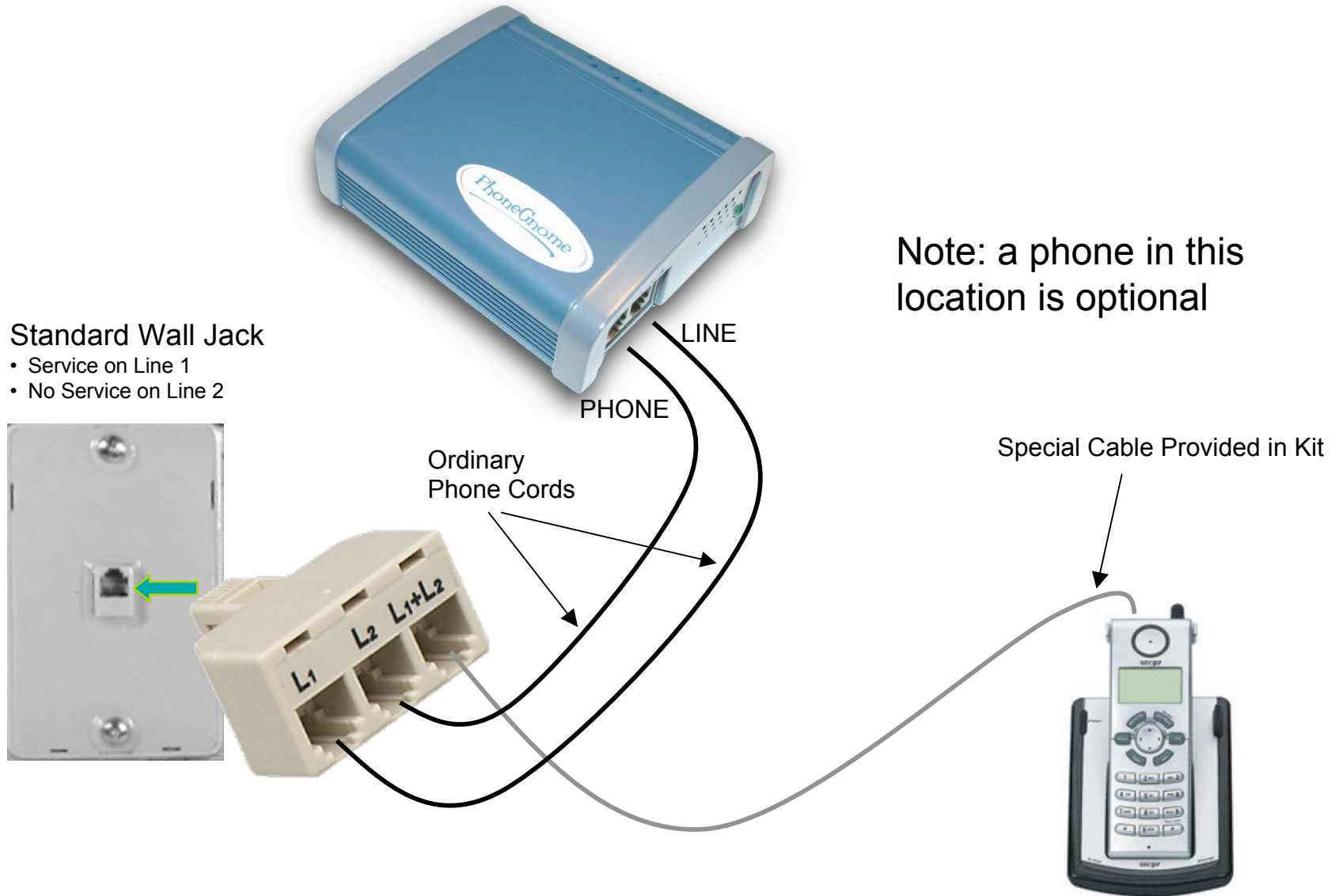

Step 4b: Phone Connections with DSL Internet (when DSL filters are required)

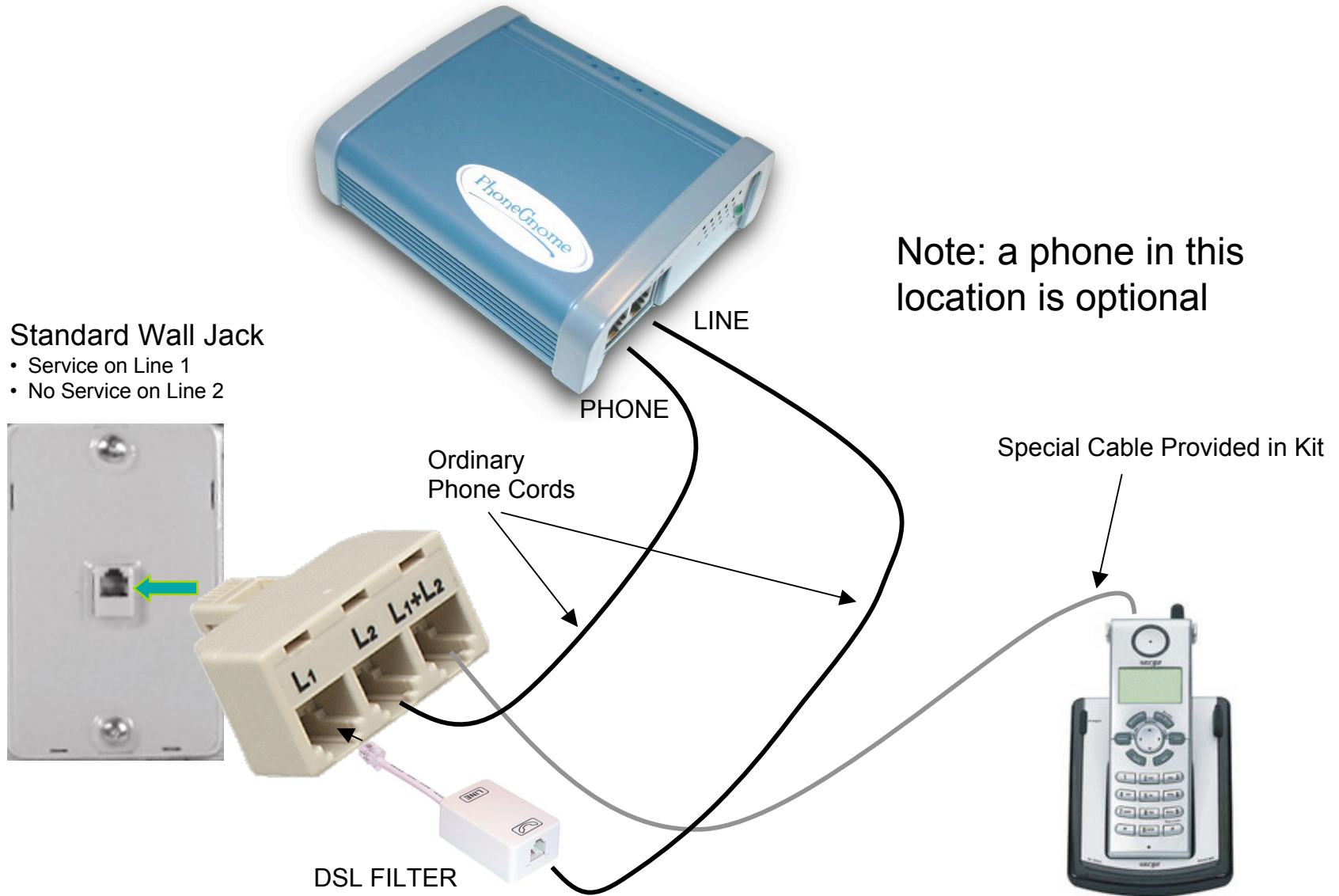

Step 5: Remaining Wall Jacks

To PhoneGnome-enable the phone, use one of the special phone cables supplied in kit without a DSL filter.

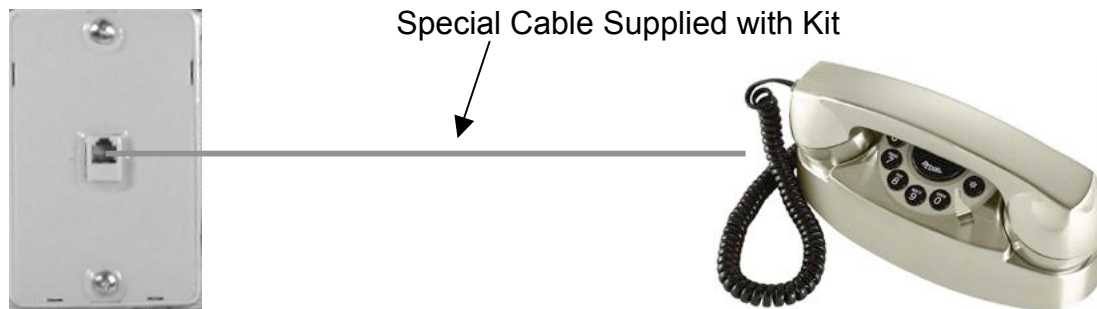

To bypass PhoneGnome and connect directly to your telephone company landline, use a standard phone cable (and DSL filter, if required)

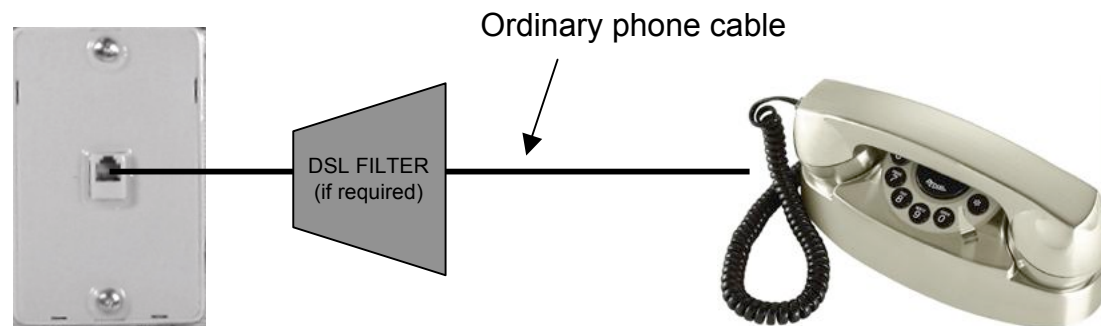

TiVo, fax machines, alarm systems, etc. should be connected as shown here